

## PE12V1.2F1



### Specifications

Nominal Voltage	12 V
Rated Capacity (20 hour rate)	1.2 Ah
Weight	1.21 lbs. (0.55 kg)
Case Material	Synthetic Resin (ABS)

### Dimensions

Length	3.82 inch (97.0mm)
Width	1.65 inch (42.0mm)
Height	2.01 inch (51.0mm)
Total Height	2.17 inch (55.0mm)

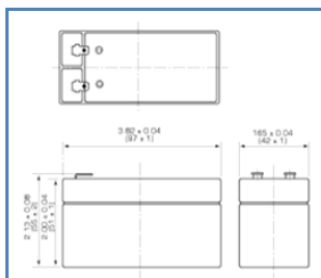

**Standard Terminal**  
F1 : AMP Fasten  
Type 187

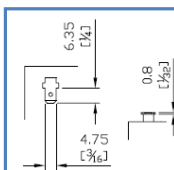

### Characteristics

Energy Density	1.14 Watt-hours/cubic inch
Specific Energy	11.9Watt-hours/pound
Maximum Discharge Current with Standard Terminals	7.2 A
Maximum Short Duration Discharge Current	18A (less than 5 sec.)
Vibration Test	No Loss Capacity or Performance (2000 cycles/minute, 0.10 excursion, 2 hours)
Charge Retention (Shelf Life)	% of Nominal Capacity at 77°F (25°C) 1 month 97% 3 month 90% 6 month 80%
Recommended Ambient Temperature Range	Charge : 32°F (0°C) to 104°F (40°C) Discharge : -4°F (-20°C) to 122°F (50°C) Storage : -4°F (-20°C) to 104°F (40°C)
Internal Resistance of Fully Charged Battery	100 milliohms

### Charging

Recommended Charging Methods	<b>CYCLE USE :</b> Maximum Initial Charge Current : 300mA Charging Voltage : 14.4 ~14.7V Charge Should Be Switched to Float Mode or Disconnected When Current Drops to 12mA
	<b>STANDBY USE (Float) :</b> Maximum Initial Charge Current : 300mA Charge Voltage : 13.5 ~13.8V

End of Discharge Voltage		Discharge Time										
		10M	15M	30M	1H	2H	3H	4H	5H	8H	10H	20H
10.8V	W	28.99	21.71	12.62	7.53	4.44	3.22	2.60	2.17	1.47	1.23	0.68
	A	2.39	1.80	1.03	0.62	0.36	0.26	0.21	0.18	0.12	0.10	0.06
10.5V	W	30.34	22.77	13.02	7.78	4.59	3.32	2.68	2.24	1.52	1.27	0.70
	A	2.51	1.89	1.06	0.63	0.38	0.27	0.22	0.18	0.12	0.10	0.06
10.2V	W	31.82	23.79	13.43	8.02	4.73	3.42	2.76	2.31	1.57	1.31	0.72
	A	2.62	1.97	1.10	0.65	0.39	0.28	0.23	0.19	0.13	0.11	0.06
9.6V	W	34.31	25.37	14.26	8.53	5.02	3.65	2.93	2.44	1.66	1.39	0.77
	A	2.83	2.09	1.17	0.70	0.42	0.30	0.24	0.20	0.14	0.11	0.07