

## PE12V2.7F1

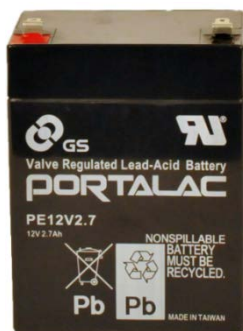

### Specifications

Nominal Voltage	12 V
Rated Capacity (20 hour rate)	2.7 Ah
Weight	2.43 lbs. (1.10 kg)
Case Material	Synthetic Resin (ABS)

### Dimensions

Length	3.11 inch (79.0mm)
Width	2.17inch (55.0mm)
Height	4.02 inch (102.0mm)
Total Height	4.17: inch (106.0mm)

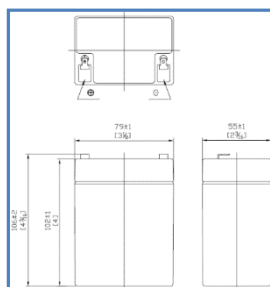

**Standard Terminal**  
F1 : AMP Fasten  
Type 187

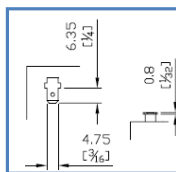

### Characteristics

Energy Density	1.20 Watt-hours/cubic inch
Specific Energy	13.4 Watt-hours/pound
Maximum Discharge Current with Standard Terminals	16.2 A
Maximum Short Duration Discharge Current	40.5 A (less than 5 sec.)
Vibration Test	No Loss Capacity or Performance (2000 cycles/minute, 0.10 excursion, 2 hours)
Charge Retention (Shelf Life)	% of Nominal Capacity at 77°F (25°C) 1 month 97% 3 month 90% 6 month 80%
Recommended Ambient Temperature Range	Charge : 32°F (0°C) to 104°F (40°C) Discharge : -4°F (-20°C) to 122°F (50°C) Storage : -4°F (-20°C) to 104°F (40°C)
Internal Resistance of Fully Charged Battery	95 milliohms

### Charging

Recommended Charging Methods	<b>CYCLE USE :</b> Maximum Initial Charge Current : 0.675A Charging Voltage : 14.4 ~14.7V Charge Should Be Switched to Float Mode or Disconnected When Current Drops to 27mA
	<b>STANDBY USE (Float) :</b> Maximum Initial Charge Current : 0.675A Charge Voltage : 13.5 ~13.8V

End of Discharge Voltage		Discharge Time										
		10M	15M	30M	1H	2H	3H	4H	5H	8H	10H	20H
10.8V	W	65.24	48.85	28.38	16.94	10.00	7.25	5.84	4.88	3.31	2.77	1.53
	A	5.37	4.06	2.33	1.39	0.82	0.59	0.48	0.40	0.27	0.23	0.13
10.5V	W	68.26	51.22	29.30	17.51	10.34	7.48	6.03	5.04	3.42	2.86	1.58
	A	5.65	4.26	2.39	1.42	0.85	0.61	0.50	0.41	0.28	0.23	0.14
10.2V	W	71.60	53.54	30.22	18.05	10.64	7.71	6.22	5.19	3.53	2.95	1.63
	A	5.90	4.43	2.46	1.46	0.88	0.63	0.51	0.43	0.29	0.24	0.14
9.6V	W	77.19	57.09	32.09	19.19	11.29	8.20	6.60	5.49	3.74	3.13	1.73
	A	6.37	4.71	2.63	1.57	0.93	0.67	0.54	0.45	0.31	0.26	0.15

