

## PE12V3AF1



### Specifications

Nominal Voltage	12 V
Rated Capacity (20 hour rate)	3 Ah
Weight	2.87 lbs. (1.30 kg)
Case Material	Synthetic Resin (ABS)

### Dimensions

Length	5.28 inch (134.0mm)
Width	2.64 inch (67.0mm)
Height	2.40 inch (61.0mm)
Total Height	2.56 inch (65.0mm)

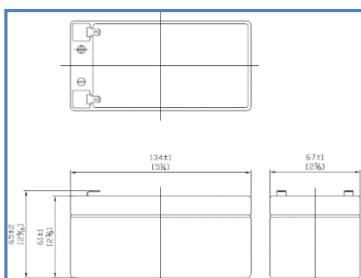

**Standard Terminal**  
F1 : AMP Fasten  
Type 187

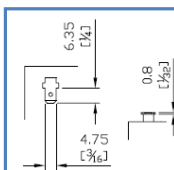

### Characteristics

Energy Density	1.08Watt-hours/cubic inch
Specific Energy	12.6 Watt-hours/pound
Maximum Discharge Current with Standard Terminals	18 A
Maximum Short Duration Discharge Current	45 A (less than 5 sec.)
Vibration Test	No Loss Capacity or Performance (2000 cycles/minute, 0.10 excursion, 2 hours)
Charge Retention (Shelf Life)	% of Nominal Capacity at 77°F (25°C) 1 month 97% 3 month 90% 6 month 80%
Recommended Ambient Temperature Range	Charge : 32°F (0°C) to 104°F (40°C) Discharge : -4°F (-20°C) to 122°F (50°C) Storage : -4°F (-20°C) to 104°F (40°C)
Internal Resistance of Fully Charged Battery	60milliohms

### Charging

Recommended Charging Methods	<b>CYCLE USE :</b> Maximum Initial Charge Current : 750mA Charging Voltage : 14.4 ~14.7V Charge Should Be Switched to Float Mode or Disconnected When Current Drops to 30mA
	<b>STANDBY USE (Float) :</b> Maximum Initial Charge Current : 750mA Charge Voltage : 13.5 ~13.8V

End of Discharge Voltage		Discharge Time										
		10M	15M	30M	1H	2H	3H	4H	5H	8H	10H	20H
10.8V	W	72.49	54.27	31.54	18.82	11.11	8.06	6.49	5.43	3.68	3.08	1.70
	A	5.97	4.51	2.58	1.54	0.91	0.66	0.53	0.45	0.30	0.25	0.14
10.5V	W	75.85	56.92	32.56	19.46	11.49	8.31	6.70	5.60	3.80	3.18	1.76
	A	6.28	4.73	2.66	1.58	0.95	0.68	0.55	0.46	0.31	0.26	0.15
10.2V	W	79.56	59.48	33.57	20.05	11.83	8.56	6.91	5.76	3.92	3.27	1.81
	A	6.56	4.92	2.74	1.63	0.98	0.70	0.57	0.47	0.32	0.27	0.16
9.6V	W	85.77	63.44	35.65	21.32	12.55	9.11	7.34	6.11	4.16	3.48	1.92
	A	7.08	5.23	2.92	1.75	1.04	0.75	0.60	0.50	0.34	0.28	0.16

