

## PE12V4.5AF1



### Specifications

|                               |                       |
|-------------------------------|-----------------------|
| Nominal Voltage               | 12 V                  |
| Rated Capacity (20 hour rate) | 4.5 Ah                |
| Weight                        | 3.86 lbs. (1.75 kg)   |
| Case Material                 | Synthetic Resin (ABS) |

### Dimensions

|              |                     |
|--------------|---------------------|
| Length       | 3.54 inch (90.0mm)  |
| Width        | 2.76 inch (70.0mm)  |
| Height       | 4.02 inch (102.0mm) |
| Total Height | 4.17 inch (106.0mm) |

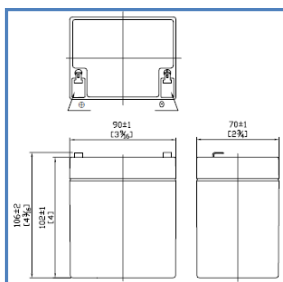

**Standard Terminal**  
F1 : AMP Fasten  
Type 187

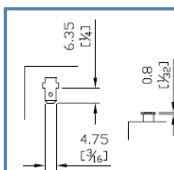

### Characteristics

|   |   |
|---|---|
| Energy Density                                    | 1.38 Watt-hours/cubic inch  |
| Specific Energy                                   | 14.0 Watt-hours/pound   |
| Maximum Discharge Current with Standard Terminals | 27 A  |
| Maximum Short Duration Discharge Current          | 67.5 A (less than 5 sec.)   |
| Vibration Test                                    | No Loss Capacity or Performance (2000 cycles/minute, 0.10 excursion, 2 hours)   |
| Charge Retention (Shelf Life)                     | % of Nominal Capacity at 77°F (25°C)<br>1 month 97%<br>3 month 90%<br>6 month 80%   |
| Recommended Ambient Temperature Range             | Charge : 32°F (0°C) to 104°F (40°C)<br>Discharge : -4°F (-20°C) to 122°F (50°C)<br>Storage : -4°F (-20°C) to 104°F (40°C) |
| Internal Resistance of Fully Charged Battery      | 70 milliohms  |

### Charging

|                              |   |
|------------------------------|---|
| Recommended Charging Methods | <b>CYCLE USE :</b><br>Maximum Initial Charge Current : 1.125A<br>Charging Voltage : 14.4 ~14.7V<br>Charge Should Be Switched to Float Mode or Disconnected When Current Drops to 45mA |
|                              | <b>STANDBY USE (Float) :</b><br>Maximum Initial Charge Current : 1.125A<br>Charge Voltage : 13.5 ~13.8V   |

| End of Discharge Voltage |   | Discharge Time |       |       |       |       |       |       |      |      |      |      |
|--------------------------|---|----------------|-------|-------|-------|-------|-------|-------|------|------|------|------|
|                          |   | 10M            | 15M   | 30M   | 1H    | 2H    | 3H    | 4H    | 5H   | 8H   | 10H  | 20H  |
| 10.8V                    | W | 108.73         | 81.41 | 47.31 | 28.23 | 16.66 | 12.08 | 9.73  | 8.14 | 5.51 | 4.61 | 2.54 |
|                          | A | 8.95           | 6.76  | 3.88  | 2.31  | 1.37  | 0.99  | 0.80  | 0.67 | 0.45 | 0.38 | 0.22 |
| 10.5V                    | W | 113.77         | 85.37 | 48.84 | 29.19 | 17.23 | 12.47 | 10.05 | 8.39 | 5.70 | 4.76 | 2.63 |
|                          | A | 9.42           | 7.09  | 3.99  | 2.37  | 1.42  | 1.02  | 0.83  | 0.69 | 0.47 | 0.39 | 0.23 |
| 10.2V                    | W | 119.33         | 89.23 | 50.36 | 30.08 | 17.74 | 12.84 | 10.37 | 8.65 | 5.88 | 4.91 | 2.72 |
|                          | A | 9.84           | 7.38  | 4.11  | 2.44  | 1.46  | 1.05  | 0.85  | 0.71 | 0.48 | 0.40 | 0.23 |
| 9.6V                     | W | 128.65         | 95.15 | 53.48 | 31.98 | 18.82 | 13.67 | 11.00 | 9.16 | 6.24 | 5.21 | 2.88 |
|                          | A | 10.61          | 7.85  | 4.38  | 2.62  | 1.56  | 1.12  | 0.90  | 0.75 | 0.51 | 0.43 | 0.25 |

