

## PE6V3A



### Specifications

Nominal Voltage	6 V
Rated Capacity (20 hour rate)	3.0 Ah
Weight	1.50 lbs. (0.68 kg)
Case Material	Synthetic Resin (ABS)

### Dimensions

Length	5.28 inch (134.0mm)
Width	1.34 inch (34.0mm)
Height	2.36 inch (60.0mm)
Total Height	2.52 inch (64.0mm)

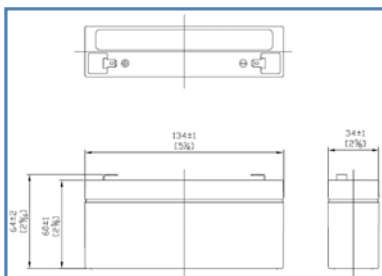

**Standard Terminal**  
F1 : AMP Fasten  
Type 187

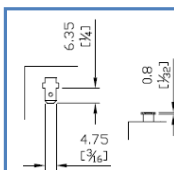

### Characteristics

Energy Density	1.08 Watt-hours/cubic inch
Specific Energy	12.0 Watt-hours/pound
Maximum Discharge Current with Standard Terminals	18 A
Maximum Short Duration Discharge Current	45 A (less than 5 sec.)
Vibration Test	No Loss In Capacity or Performance (2000 cycles/minute, 0.10 excursion, 2 hours)
Charge Retention (Shelf Life)	% of Nominal Capacity at 77°F (25°C) 1 month 97% 3 month 90% 6 month 80%
Recommended Ambient Temperature Range	Charge : 32°F (0°C) to 104°F (40°C) Discharge : -4°F (-20°C) to 122°F (50°C) Storage : -4°F (-20°C) to 104°F (40°C)
Internal Resistance of Fully Charged Battery	50 Milliohms

### Charging

Recommended Charging Methods	<b>CYCLE USE :</b> Maximum Initial Charge Current : 750mA Charging Voltage : 7.20 ~7.35V Charge Should Be Switched to Float Mode or Disconnected When Current Drops to 30mA
	<b>STANDBY USE (Float) :</b> Maximum Initial Charge Current : 750mA Charge Voltage : 6.75 ~6.90V

End of Discharge Voltage		Discharge Time										
		10M	15M	30M	1H	2H	3H	4H	5H	8H	10H	20H
5.40V	W	36.24	27.14	15.77	9.41	5.55	4.03	3.24	2.71	1.84	1.54	0.85
	A	5.97	4.51	2.58	1.54	0.91	0.66	0.53	0.45	0.30	0.25	0.14
5.25V	W	37.92	28.46	16.28	9.73	5.74	4.16	3.35	2.80	1.90	1.59	0.88
	A	6.28	4.73	2.66	1.58	0.95	0.68	0.55	0.46	0.31	0.26	0.15
5.10V	W	39.78	29.74	16.79	10.03	5.91	4.28	3.46	2.88	1.96	1.64	0.91
	A	6.56	4.92	2.74	1.63	0.98	0.70	0.57	0.47	0.32	0.27	0.16
4.80V	W	42.88	31.72	17.83	10.66	6.27	4.56	3.67	3.05	2.08	1.74	0.96
	A	7.08	5.23	2.92	1.75	1.04	0.75	0.60	0.50	0.34	0.28	0.16

