

## PE6V8F1



### Specifications

Nominal Voltage	6 V
Rated Capacity (20 hour rate)	8 Ah
Weight	3.35 lbs. (1.52 kg)
Case Material	Synthetic Resin (ABS)

### Dimensions

Length	3.86 inch (98.0mm)
Width	2.20 inch (56.0mm)
Height	4.65 inch (118.0mm)

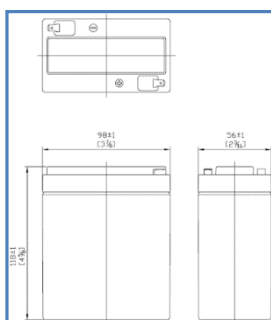

**Standard Terminal**  
F1 : AMP Fasten  
Type 187

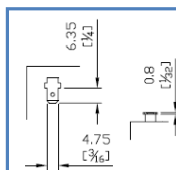

### Characteristics

Energy Density	1.21 Watt-hours/cubic inch
Specific Energy	14.3 Watt-hours/pound
Maximum Discharge Current with Standard Terminals	48 A
Maximum Short Duration Discharge Current	120 A (less than 5 sec.)
Vibration Test	No Loss Capacity or Performance (2000 cycles/minute, 0.10 excursion, 2 hours)
Charge Retention (Shelf Life)	% of Nominal Capacity at 77°F (25°C) 1 month 97% 3 month 90% 6 month 80%
Recommended Ambient Temperature Range	Charge : 32°F (0°C) to 104°F (40°C) Discharge : -4°F (-20°C) to 122°F (50°C) Storage : -4°F (-20°C) to 104°F (40°C)
Internal Resistance of Fully Charged Battery	21 Milliohms

### Charging

Recommended Charging Methods	<b>CYCLE USE :</b> Maximum Initial Charge Current : 2A Charging Voltage : 7.20 ~7.35V Charge Should Be Switched to Float Mode or Disconnected When Current Drops to 80mA
	<b>STANDBY USE (Float) :</b> Maximum Initial Charge Current : 2A Charge Voltage : 6.75 ~6.90V

End of Discharge Voltage		Discharge Time										
		10M	15M	30M	1H	2H	3H	4H	5H	8H	10H	20H
5.40V	W	96.65	72.37	42.05	25.10	14.81	10.74	8.65	7.24	4.90	4.10	2.26
	A	15.92	12.02	6.89	4.11	2.43	1.76	1.42	1.19	0.80	0.67	0.38
5.25V	W	101.13	75.89	43.41	25.95	15.32	11.08	8.93	7.46	5.07	4.24	2.34
	A	16.74	12.61	7.09	4.22	2.52	1.81	1.47	1.22	0.83	0.69	0.40
5.10V	W	106.07	79.31	44.77	26.74	15.77	11.42	9.22	7.69	5.23	4.37	2.42
	A	17.50	13.12	7.30	4.34	2.60	1.87	1.51	1.26	0.86	0.71	0.42
4.80V	W	114.35	84.58	47.54	28.43	16.73	12.15	9.78	8.14	5.55	4.64	2.56
	A	18.87	13.95	7.79	4.66	2.77	1.99	1.60	1.33	0.91	0.76	0.44